



ASSEMBLY INSTRUCTION

ITEM#:4558-15

DESCRIPTION:COMPUTHER DESK

NO.	PARTS LIST		QTY	NO.	HARDWARE LIST		QTY
					HARDWARE PACK IN		
A		GLASS TOP	1	1		BOLT M6x8mm	4
				2		BOLT M6x25mm	3
B		TOP SHELF	1	3		BOLT M6x55mm	4
				4		BOLT M6x345mm	6
C		MIDDLE SHELF	1	5		NUT M6x5	6
				6		COVER Ø59x4	4
D		BOTTOM SHELF	1	7		DOWEL Ø6x30	8
				8		FLAT WASHER Ø16xØ7x1.0	13
E		SIDE BOARD	2	9		ADJUSTABLE FOOT M6x16	2
F		METAL CROSS LEG	1	10		ALLEN KEY M4	1
				11		WRENCH	1
G		SUPPORT TUBE	2				
H		SWIVEL PLATE	1				

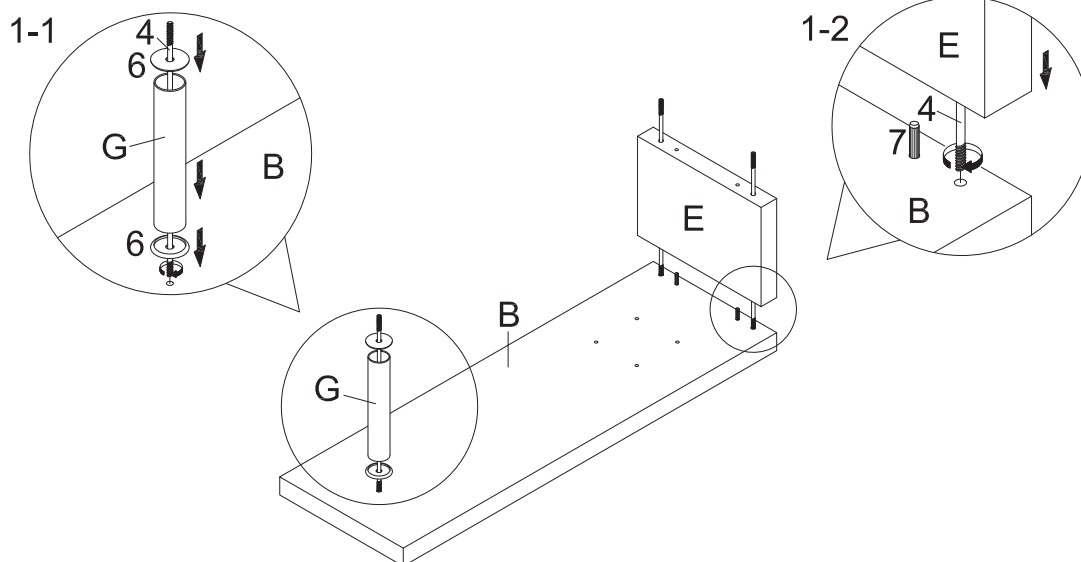

STEP 1

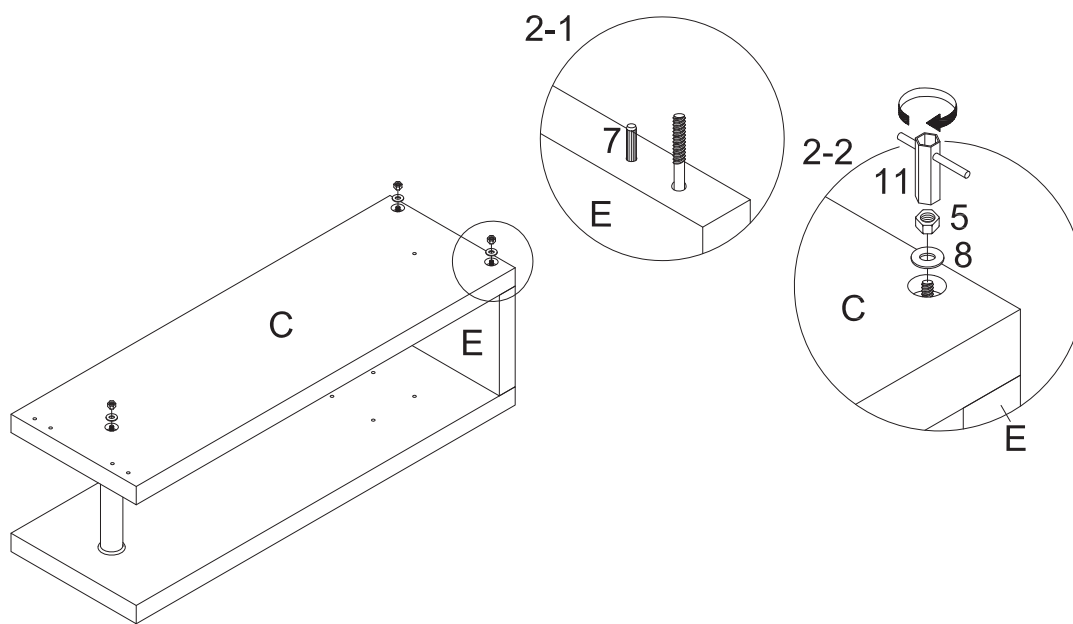

STEP 2

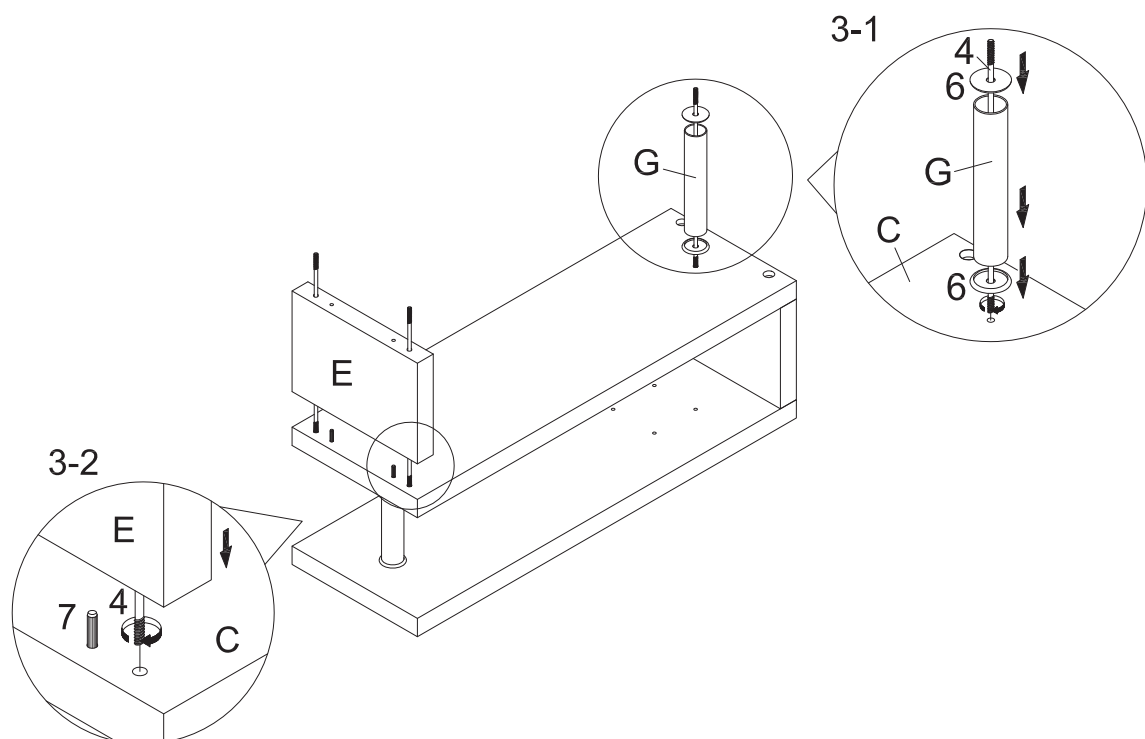

STEP 3



For items use on wooden floor, hard surfaces or carpets, it is recommended to install protective pads under all legs and supports to avoid/prevent from damages/scratches and discoloration

Do not tighten bolts until completely assembled

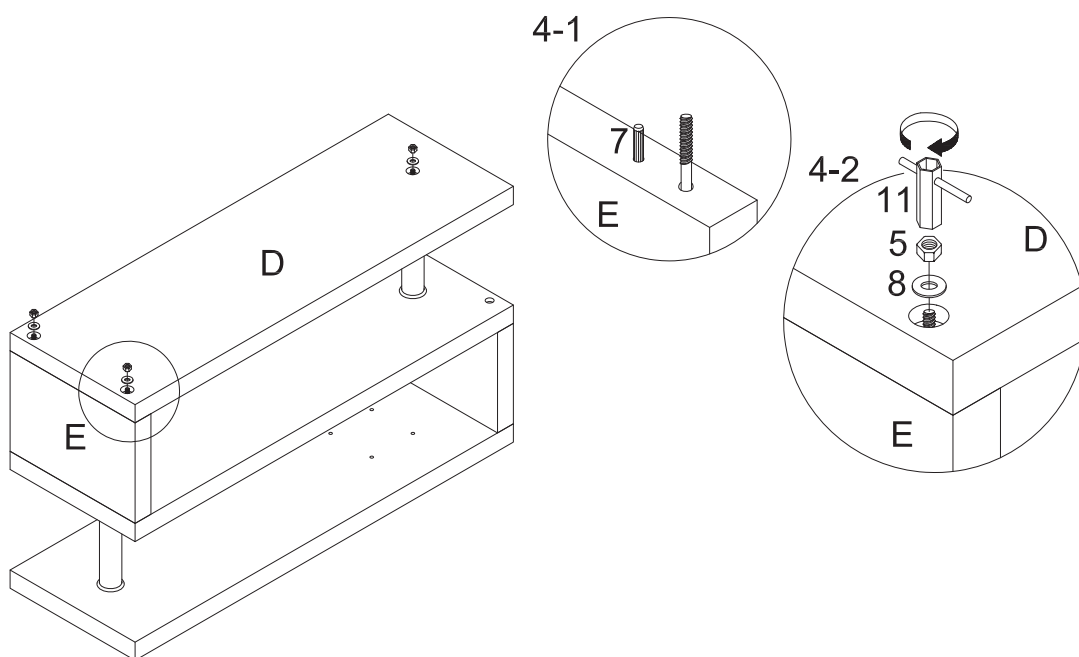

STEP 4

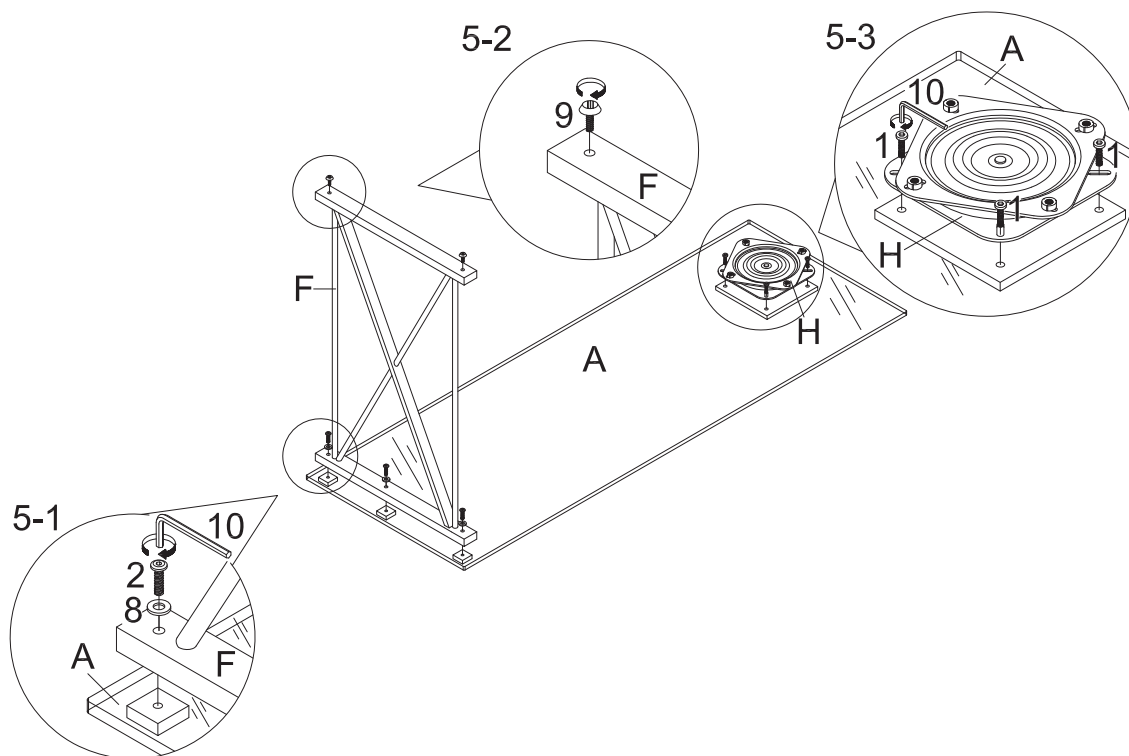

STEP 5



For items use on wooden floor, hard surfaces or carpets, it is recommended to install protective pads under all legs and supports to avoid/prevent from damages/scratches and discoloration

Do not tighten bolts until completely assembled

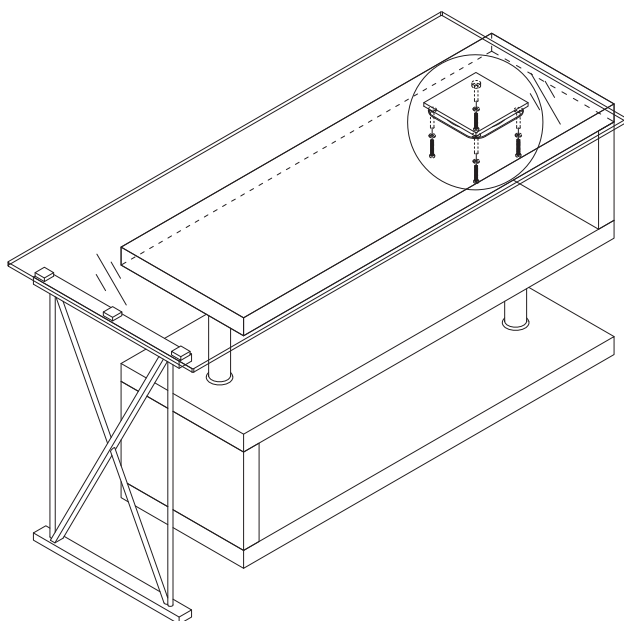

6-1

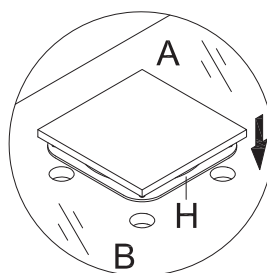

6-2

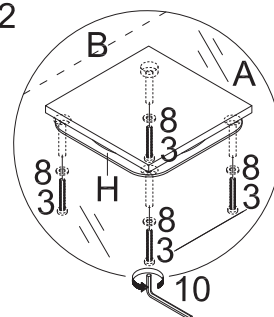

STEP 6

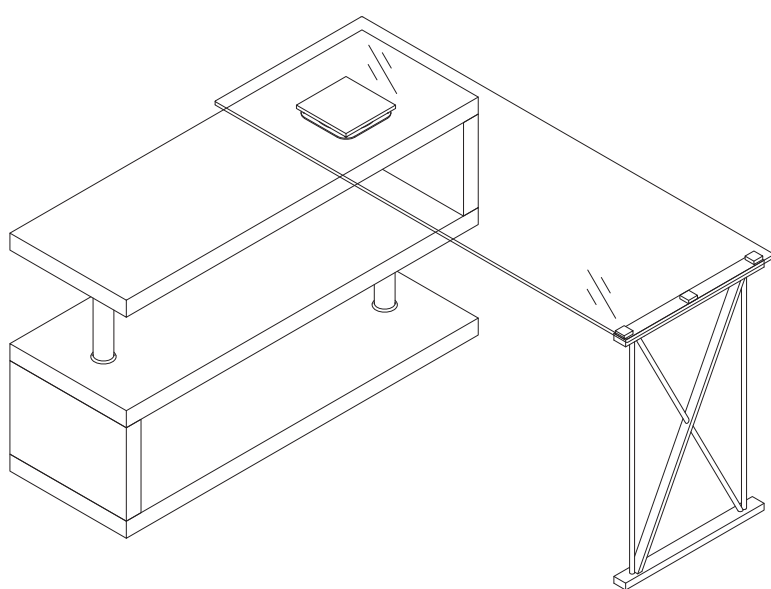
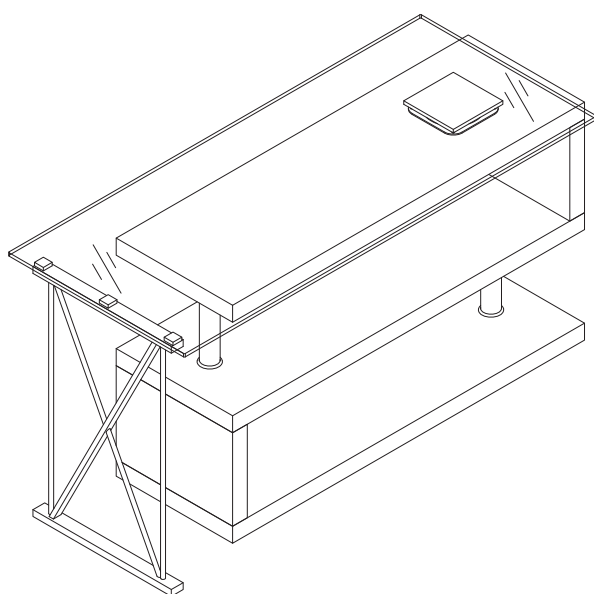

STEP 7
COMPLETED



For items use on wooden floor, hard surfaces or carpets, it is recommended to install protective pads under all legs and supports to avoid/prevent from damages/scratches and discoloration

Do not tighten bolts until completely assembled